

253 Tompkins on the park

PENTHOUSE

SIXTH FLOOR
2 BEDROOMS
2 BATHROOMS

1,150 INTERIOR SQUARE FEET
(107 SQUARE METERS)
325 EXTERIOR SQUARE FEET
(30 SQUARE METERS)

FULL-FLOOR PENTHOUSE RESIDENCE

EXPANSIVE GREAT ROOM WITH LARGE ISLAND KITCHEN

WRAPAROUND TERRACE ACCESSED FROM GREAT ROOM AND
MASTER BEDROOM THROUGH THREE SETS OF FRENCH DOORS

MASTER BEDROOM WITH EN-SUITE BATHROOM
AND WALK-IN CLOSET

WASHER/DRYER

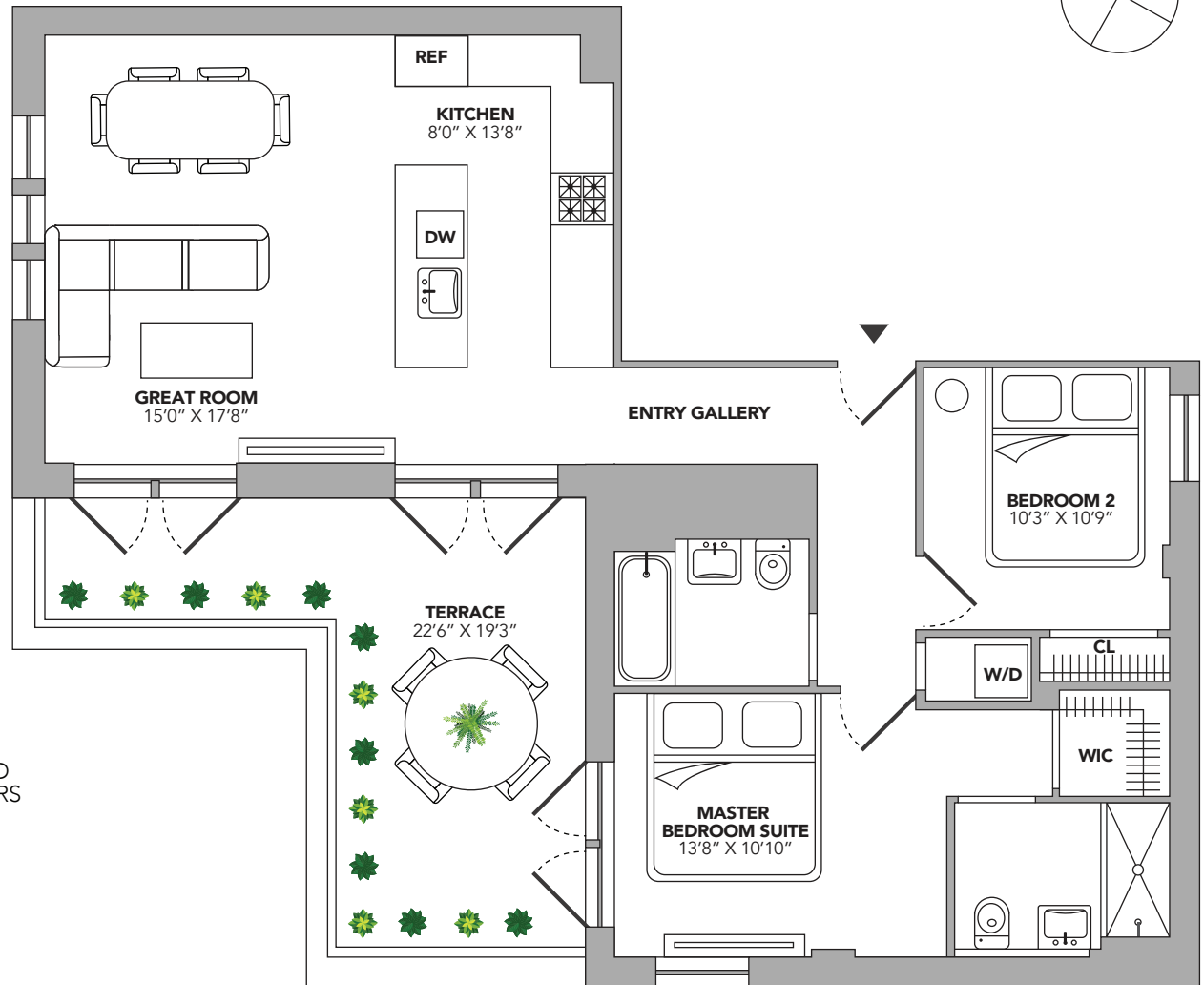

corcoran
EXCLUSIVE MARKETING & SALES AGENT

Avi Alkotzer
Licensed Real Estate Salesperson
212.941.2624 | avi.alkotzer@corcoran.com

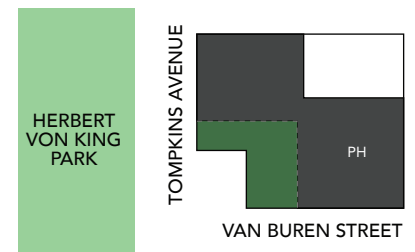

All dimensions are approximate and subject to normal construction variances and tolerances. Plans and dimensions may contain minor variations from floor to floor. The square footage on this floor plan exceeds the usable square footage. The furniture depicted herein is not included in the sale of the Unit. The complete Offering Terms are in an Offering Plan available from the Sponsor, File No. CD18-0441. Equal Housing Opportunity.